



**FlexScan**<sup>®</sup>  
Business Monitor Solutions



Now, find your workstyle.

Both performance and environmental consciousness are important in today's society.

FlexScan combines cutting-edge technology with sustainable design to achieve the ideal in workstyle innovation.

Whether it be in the office or at home, FlexScan enables business professionals to achieve comfort and efficiency while staying kind to the environment.

**Now, find your workstyle.**



**FlexScan®**



Open-Plan Office



Satellite Office





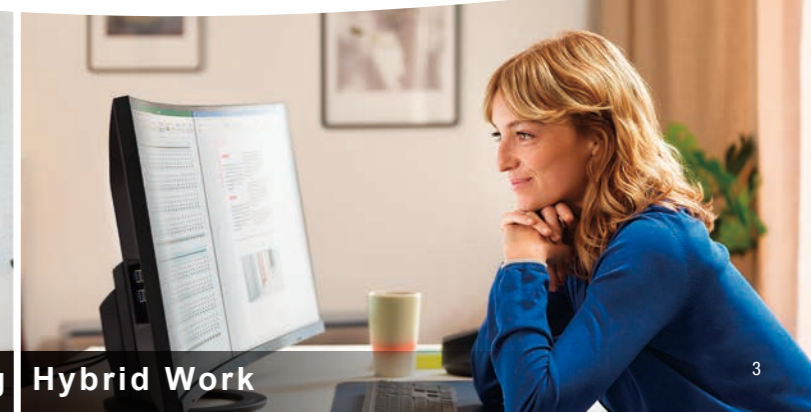









Telecommuting



Hybrid Work

# Find the Solution that Suits Your Workstyle Needs

		Premium						New Standard			Basic			
		<ul style="list-style-type: none"> <li>I need a stable network connection for web meetings <i>See page 9</i></li> </ul>												
		<ul style="list-style-type: none"> <li>I need to use multiple monitors with less cable clutter <i>See page 9</i></li> </ul>												
		<ul style="list-style-type: none"> <li>Having my battery always fully charged allows me to focus on work <i>See page 8</i></li> </ul>									I'm using a desktop PC and need a good monitor			
		<ul style="list-style-type: none"> <li>I prefer to work with an external mouse and keyboard when using my laptop <i>See page 8</i></li> </ul>												
		Eye care and ergonomics are important to me <i>See pages 10 - 12</i>												
		I want to coordinate the monitor with the space <i>See pages 6 - 7</i>												
Inputs	USB Type-C®	✓	✓	✓	✓	✓	✓	✓	✓	✓				
	• Network Connection	✓	✓	✓	✓	✓	✓							
	• Daisy Chain				✓	✓	✓							
	• Power Delivery	✓	✓	✓	✓	✓	✓	✓	✓	✓				
	• Connect Peripherals	✓	✓	✓	✓	✓	✓	✓	✓	✓				
	DisplayPort™	✓	✓	✓	✓	✓	✓	✓	✓	✓	✓	✓	✓	✓
	HDMI®	✓	✓	✓	✓	✓	✓	✓	✓	✓	✓	✓	✓	✓
	DVI-D										✓	✓	✓	
	D-Sub mini 15 pin											✓	✓	✓
Eye Care Functions	✓	✓	✓	✓	✓	✓	✓	✓	✓	✓	✓	✓	✓	
Frameless	✓	✓	✓	✓	✓	✓	✓	✓	✓	✓	✓	✓	✓	
Color	White / Black	White / Black	White / Black	White / Black	White / Black	White / Black	White / Black	White / Black	White / Black	White / Black	White / Black	White / Black	White / Black	
USB Ports	4	4	4	4	4	4	4	4	4	4	2	4	2	
Panel Size	37.5"	31.5"	27"	27"	24.1"	23.8"	27"	24.1"	23.8"	27"	24.1"	23.8"	22.5"	
Native Resolution	UWQHD+ 3840×1600	4K 3840×2160	4K 3840×2160	WQHD 2560×1440	WUXGA 1920×1200	Full HD 1920×1080	WQHD 2560×1440	WUXGA 1920×1200	Full HD 1920×1080	WQHD 2560×1440	WUXGA 1920×1200	Full HD 1920×1080	WUXGA 1920×1200	
		<b>NEW</b> 	<b>NEW</b> 											
	EV3895	EV3240X	EV2740X	EV2795	EV2495	EV2490	EV2781	EV2485	EV2480	EV2760	EV2456	EV2460	EV2360	

See pages 20 - 23 for a detailed list and specifications of the complete FlexScan lineup, including square and wide monitors.

# Bask in Beauty

NEW FlexScan EV3240X / EV2740X



## Aesthetically Pleasing Design

### Bezels that are Barely There

These monitors are virtually frameless. Even with the black borders along the perimeter of the LCD there is very little distance between the display area of each screen in a multi-monitor configuration which makes for almost seamless viewing.

### Color Coordination

The monitor is available in white, for a brighter office environment, or black, for a sleek and stylish mood. The cables and stand also come in matching colors for a fully coordinated look.



## Reach Your Full Potential in 4K

The EV3240X / EV2740X support 4K (3840 x 2160 pixel) resolution, displaying four times the amount of information than standard Full HD (1920 x 1080 pixel) monitors. With 4K, you can display more applications simultaneously on a single screen, greatly reducing the need to scroll or switch windows frequently.

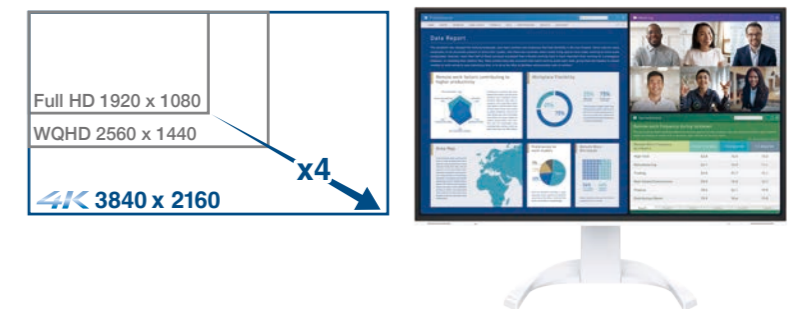

Visualize your Workspace with AR



EV3240X



EV2740X



# Streamlined Connection with USB Type-C



## A Better Working Experience

USB Type-C compatible monitors make it faster and easier to connect a laptop when moving between workstations, or when working away from the office.

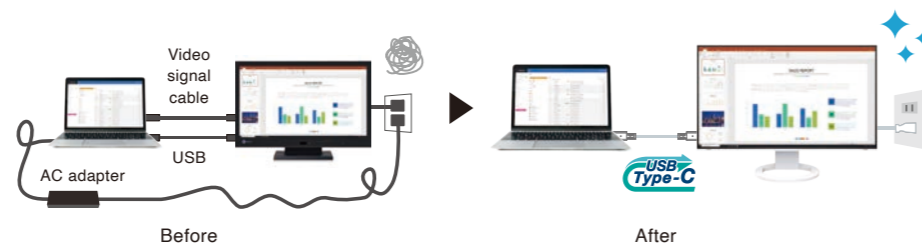

## Power Delivery

Power delivery via USB Type-C reliably charges laptops and small desktop PCs. This eliminates the need for a laptop's bulky power supply unit, freeing up desk space.



## Connect Peripherals

Laptops often have limited connectivity options for peripherals. Connecting to a USB Type-C compatible monitor gives access to a hub with multiple USB Type-A ports for easily connecting an external keyboard, mouse, web camera, or storage device.



Compatible Models EV3895 / EV3240X / EV2740X / EV2795 / EV2495 / EV2490 / EV2781 / EV2485 / EV2480

[Visit Our Website](#) | Infographic: "What is USB Type-C?"

## Network Connection

While many modern laptops are not equipped with a dedicated LAN port, a USB Type-C compatible monitor with a built-in LAN adapter provides users with access to the network via the monitor. This allows users to conduct conference calls or data transfers reliably and at high speed.



Compatible Models EV3895 / EV3240X / EV2740X / EV2795 / EV2495 / EV2490

## Protecting Network Security in Shared Workspaces

Social change has led to a diversification of workspace models and workstyles. More companies are adopting shared office spaces, conference rooms, and meeting spaces. EIZO MAC Address Clone Utility software is available to enable the convenient use of wired LAN functions in a secure environment through MAC address authentication when using EIZO LAN port monitors in such spaces. *Supports Windows OS only.*



## Daisy Chain

With a daisy chain users can connect multiple monitors via a single video signal output. Connecting monitors in a daisy chain simplifies cable management, tidying up the back of the desk for an even cleaner office aesthetic.

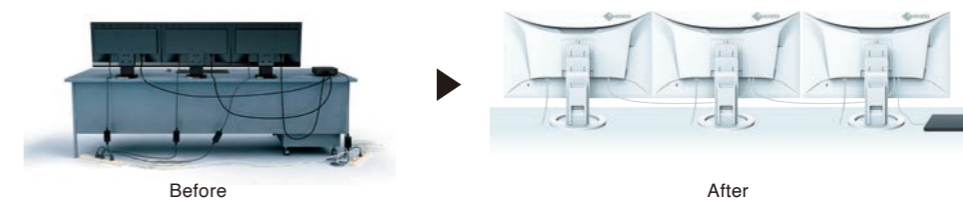

Compatible Models EV2795 / EV2495 / EV2490

[Visit Our Website](#) | What do I need to know about daisy chaining?

# Say Goodbye to Tired Eyes



## Glare Reduction

### Anti-Glare Coating

FlexScan monitors are treated with an anti-glare coating to reduce screen reflections caused by ambient lighting. The coating scatters incoming light, reducing the amount of light reflected into your eyes.

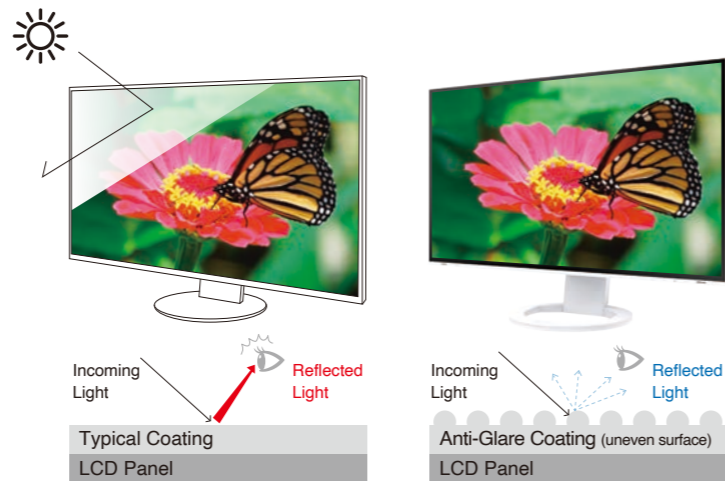

## Flicker-Free Viewing

### EyeCare Dimming Mode

In low brightness ranges, users may perceive flicker on a typical LED backlight, causing eye fatigue and often headaches. EyeCare is a dimming function that cuts flicker to a degree that human eyes cannot detect, reducing eye fatigue and flicker-related headaches, without affecting color stability of the monitor.



FlexScan monitors are certified by TÜV Rheinland to have low blue light and be flicker-free.



## Auto Brightness Control

### Always the Ideal Brightness

The Auto EcoView function automatically adjusts the brightness of your monitor according to ambient lighting. This ensures your monitor is always at the optimal brightness for reducing eye fatigue.



## Blue Light Reduction

### Paper Mode

Do you find that your screen is often too bright to read text comfortably? FlexScan monitors are equipped with Paper Mode which reduces blue light to simulate paper, making it less straining on your eyes. When used in conjunction with the Auto EcoView function, blue light is even further reduced.

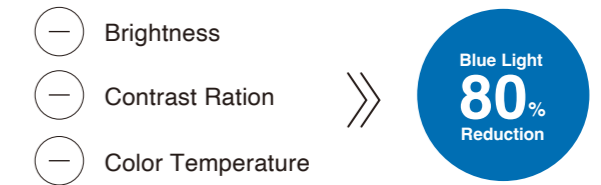

## Stable Image Even at Low Brightness

### Reduce Brightness to Approximately 1 cd/m<sup>2</sup>

Frameless and wide monitors can be adjusted to a brightness of approximately 1 cd/m<sup>2</sup> without negatively impacting the color or stability of the screen.

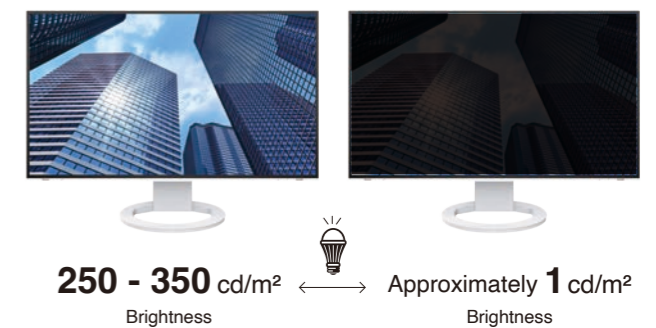

[Visit Our Website](#) | "The Latest on Computer Screens and Eye Fatigue"

[Visit Our Website](#) | "Designed to Protect Your Eyes"

# The Perfect Position



## Space-Saving Positioning

For the most limited workspaces, a laptop can fit comfortably under the monitor with the stand at maximum height. This allows you to use the laptop as a second screen without taking up valuable desktop space.

*The specific movement ranges of stands varies by model. See pages 20 - 23 for specifications of all monitors.*

## Portrait Mode

View web pages and documents easily by switching the monitor to portrait mode simply by rotating the screen.

*The specific movement ranges of stands varies by model. See pages 20 - 23 for specifications of all monitors.*

### ■ EV2480

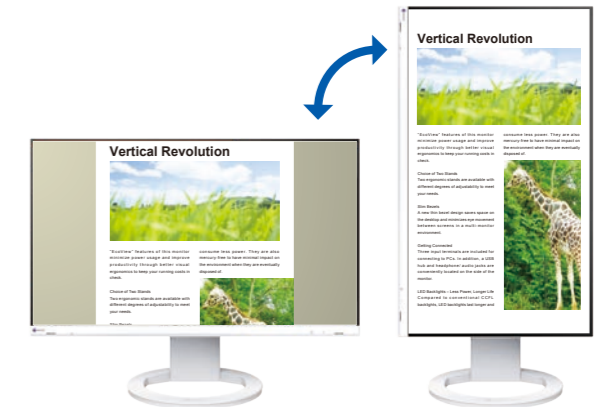
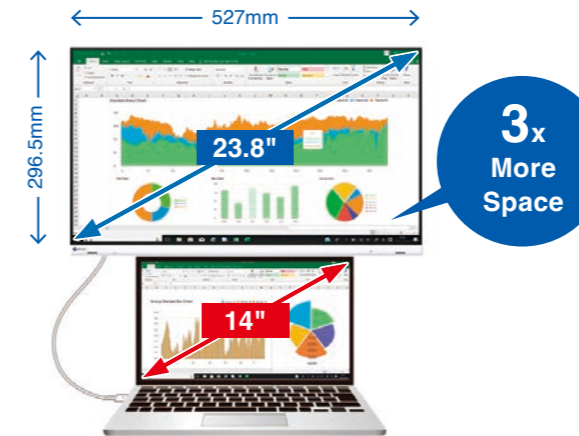

## Versatile Stand

The stands feature height adjustment, tilt, and swivel, while saving space and remaining stylish. Quickly and smoothly adjust your monitor to the perfect position.

*The specific movement ranges of stands varies by model. See pages 20 - 23 for specifications of all monitors.*

### ■ EV2795 / EV2781

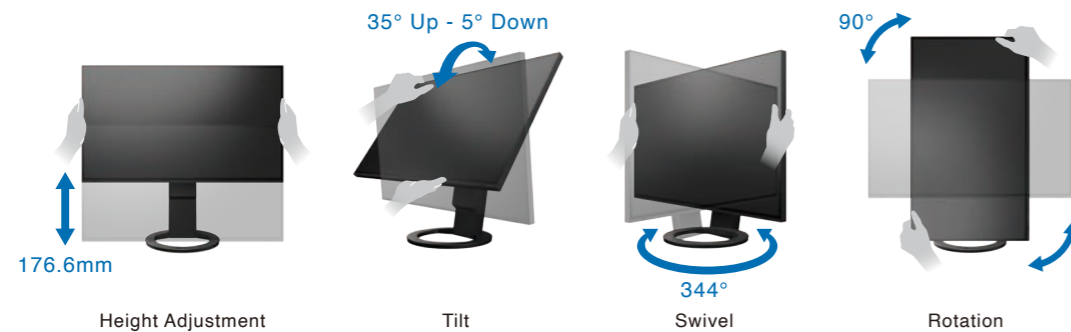

## Wide Height Adjustment Range

The ergonomic stand allows you to adjust the monitor to the most comfortable position suited for the workplace or home office.

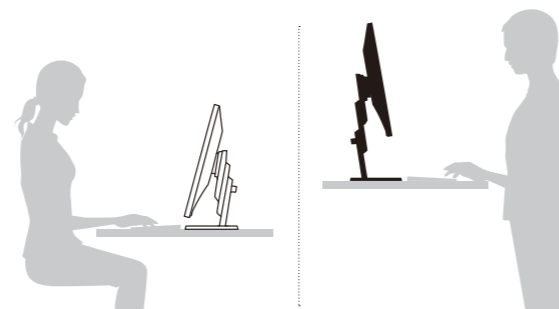

## Free Up Your Workspace

VESA-compliant stand brackets let you easily mount a client terminal such as a thin client or mini PC to the back of the monitor. The space the client terminal previously occupied is now freed up so you can make better use of your desktop. Even with the client terminal attached you can adjust the monitor's stand freely.

*Please check EIZO website for supported models.*

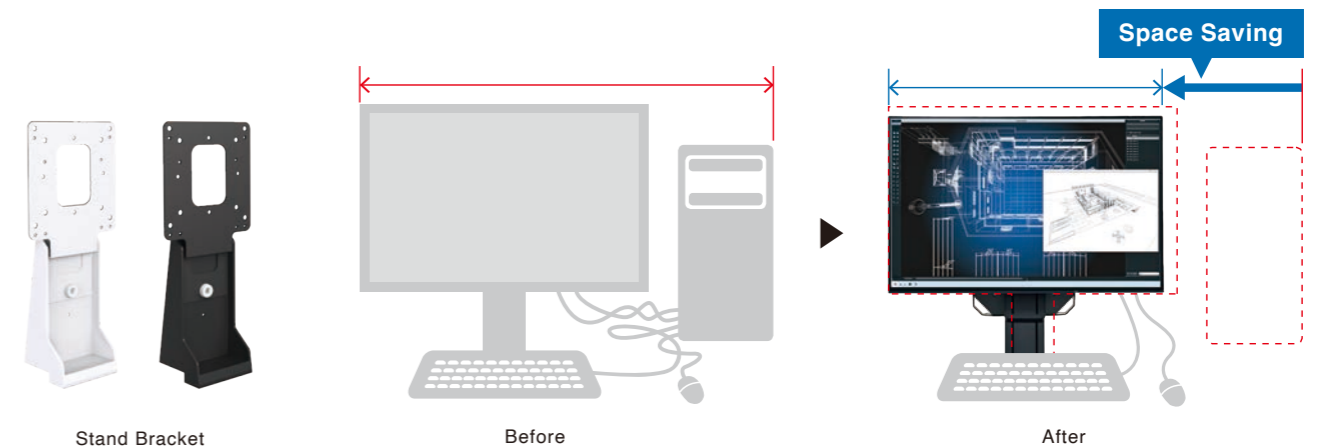

# Intelligent Software to Work Better

## SCREEN INSTYLE

EIZO's free Screen InStyle software automatically optimizes your monitor to make your user environment more comfortable.

See pages 20 - 23 for compatible monitors.

Compatible OS Windows 11 / 10

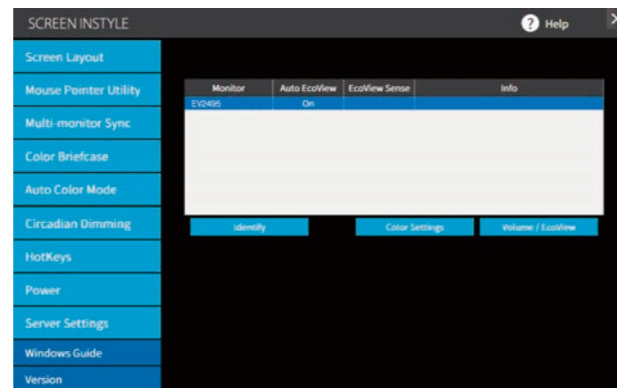

## Automatically Change the Color Mode for Each Application

### Auto Color Mode

FlexScan monitors have multiple color modes designed for different uses. Use the Auto Color Mode to assign a color mode to turn on when using specific applications such as those for writing documents, photo viewing, creating illustrations or watching movies. When an application is opened the screen will automatically switch to the assigned color mode, making manual switching unnecessary.



## Organize Your Desktop to Increase Work Efficiency

### Screen Layout

This function allows you to divide the desktop and arrange each program's window neatly across the screen to help you work smart and efficiently.



## Easily Switch Between Inputs / Color Modes

### Assign Hotkeys for Switching Input Signals and Color Modes

You can assign keyboard hotkeys to switch between color modes or input signals of two PCs connected to your monitor.

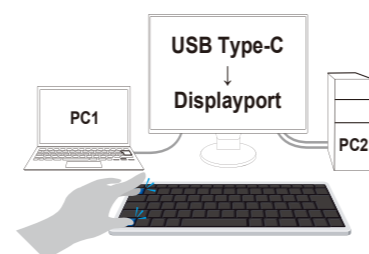

## Multi-Monitor Convenience

### Synchronize Screen Adjustments

When using multiple monitors, save time by synchronizing all the monitors with each other. If you change the color mode, brightness or color temperature of one monitor, the rest will automatically change to the same.

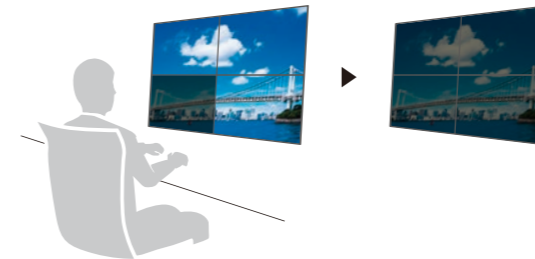

### On/Off All at Once

When one monitor's power is turned off, all other monitors will also turn off. Save energy by easily turning off all monitors at once.

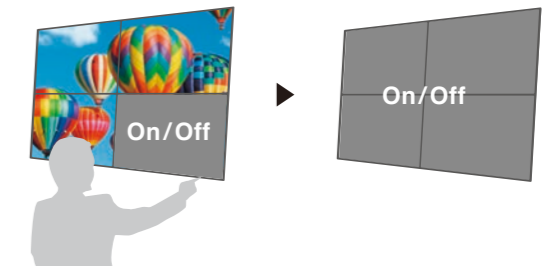

## Screen InStyle Server

## Effectively Monitor Asset Management

### Automatically Receive Monitor or PC Information

With Screen InStyle Server receive information such as the model name and serial number of any monitor connected to your network. Additionally, see information from the computer that each monitor is connected to, such as the OS, IP address and computer name.

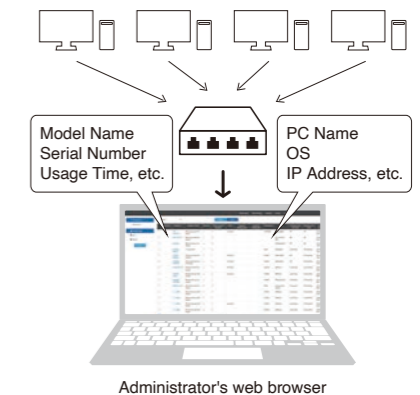

## Control Settings on Multiple Monitors at Once

### Manage Multiple Monitors from One Location

Control multiple monitors' settings such as color mode, brightness, and eco functions from a remote location. Furthermore, prevent unintended setting changes by locking the operation switch.

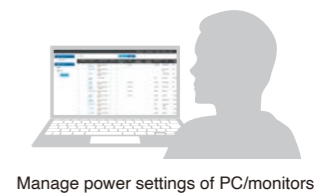

### Conserve Power with Central Management

Manage various power settings of networked PCs and monitors. Set the monitor to turn off or the PC to sleep after a set period of inactivity.

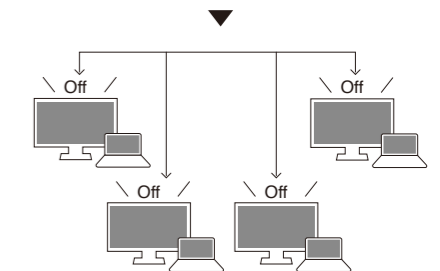

### Improve Security with Automatic Locking

Improve office security by setting networked PCs to automatically lock after a certain period of inactivity. This ensures the PC remains secure after the user leaves their desk.

Download Screen InStyle and Screen InStyle Server >>>





# Care for the Environment



## Sustainable Monitor Design

Achieving a sustainable society where we do no harm to the environment nor waste precious resources is an important initiative for businesses and communities. FlexScan Sustainable Monitors are at the forefront of EIZO's efforts to contribute to this sustainable future.

Learn more about EIZO Sustainable Monitors



## Conserve to Preserve

FlexScan Sustainable Monitors include models which are made of more than 80% recycled plastic. This cuts down on the amount of plastic waste going into the environment, conserves resources, and promotes reuse of materials for preserving our natural ecosystems.



## Effortlessly Save on Power Consumption

FlexScan Sustainable Monitors' Auto EcoView function automatically adjusts the screen's brightness according to changes in the ambient lighting. The EcoView Optimizer 2 function fine-tunes the balance between brightness and gain according to the content displayed on the screen. These proprietary EcoView technologies cut power consumption by as much as 50%\* compared to displaying at maximum brightness.

\*Typical power consumption when not using USB power delivery



Visit Our Website

"How Green is Your Monitor?" Eco Calculator



## Cushioning Environmental Impact

Starting with the most recent models, FlexScan Sustainable Monitors are moving away from using plastic and styrofoam in the packaging to reduce environmental impact. The monitors are safely packed using molded pulp, which is made from recycled cardboard and newspaper, and cables are wrapped in paper instead of plastic bags.



## Collective Environmental Consciousness

EIZO offers corporate customers an option for collective packaging, where multiple monitors can be packed together in a single box. We can also leave out any unneeded stands or cables. This reduces the amount of packaging materials used, improves loading efficiency, and significantly reduces unpacking and installation time, leading to less overall waste.



## Certified Sustainable

EIZO complies with international laws and regulations regarding environmental protection and effective use of energy. In addition, FlexScan Sustainable Monitors meet the latest environmental standards, such as ENERGY STAR®, EPEAT, and TCO Certified Generation 9.



## Our Contribution to SDGs

As part of its corporate social responsibility (CSR) activities, EIZO is contributing towards the United Nations' Sustainable Development Goals (SDGs).

## SUSTAINABLE DEVELOPMENT GOALS



# Visual Technology Company



50+ Years of Expertise

Innovative Solutions

Extensive Market Reach

## Built-In Color Calibration Sensors



Automatically calibrates while you work



FlexScan

## Business Enterprise



ColorEdge

## Creative Work

## IP Decoding Solutions



## Visibility Enhancement Technology



Ultra-High Sensitivity HD Cameras

Image Optimization System



Research and Development



Global Reach

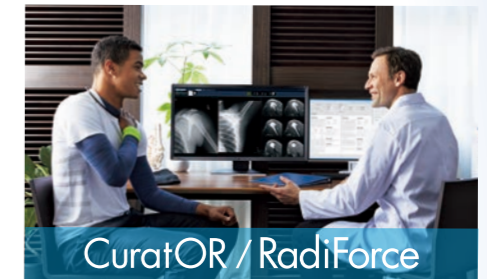

CuratOR / RadiForce

## Healthcare

## Market-Focused Cloud Solutions



Air Traffic Control

Creative Work

Healthcare



## Manufacturing



## Quality Control



## Customization



DuraVision

## Security & Surveillance / Maritime

## Software for Improved Workflow



Use a single mouse across two PCs

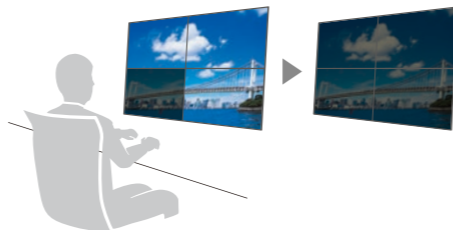

Synchronized adjustment of multiple monitors



Simplified CMS with automatic software and printer settings adjustment



Raptor / Re/Vue / SafeGuard

## Air Traffic Control





# EIZO Corporation

153 Shimokashiwano, Hakusan, Ishikawa 924-8566 Japan  
Phone +81-76-277-6794

<https://www.eizoglobal.com>

EIZO, the EIZO logo, FlexScan, ColorEdge, CuratOR, RadiForce, DuraVision, Raptor, and ScreenManager are registered trademarks of EIZO Corporation. EIZO ScreenSlider, Re/Vue, SafeGuard and Screen InStyle are trademarks of EIZO Corporation. The terms HDMI and HDMI High-Definition Multimedia Interface, and the HDMI Logo are trademarks or registered trademarks of HDMI Licensing, LLC in the United States and other countries. DisplayPort and VESA are trademarks of the Video Electronics Standards Association in the United States and other countries. Windows, Microsoft are registered trademarks of Microsoft Corporation in the United States and other countries. DICOM is the registered trademark of the National Electrical Manufacturers Association for its standards publications relating to digital communications of medical information. USB Type-C is a registered trademark of USB Implementers Forum, Inc. macOS Sierra is a registered trademark of Apple Inc. ENERGY STAR is a registered trademark of the United States Environmental Protection Agency in the United States and other countries. All other company names, product names, and logos are trademarks or registered trademarks of their respective owners. Some screen images are used with permission from Microsoft. Specifications are subject to change without notice.

Copyright © 2023 EIZO Corporation. All rights reserved. (230402B)

